

RAILWAY PLACE SOUTH, GOORNONG

GB5078

FOOTPATH RENEWAL

MAY 2023

DOCUMENT CONTROL				
SHEET No.	SHEETD ESC.	30/05/2023	xx/xx/xx	xx/xx/xx
		DRAFT	TENDER	CONSTRUCTION
		REVISION	REVISION	REVISION
1	COVER SHEET	A		
2	GENERAL NOTES	A		
3-7	DETAIL LAYOUT	A		
8-9	ROAD CROSS SECTIONS	A		
10	SETOUT	A		



LOCALITY MAP

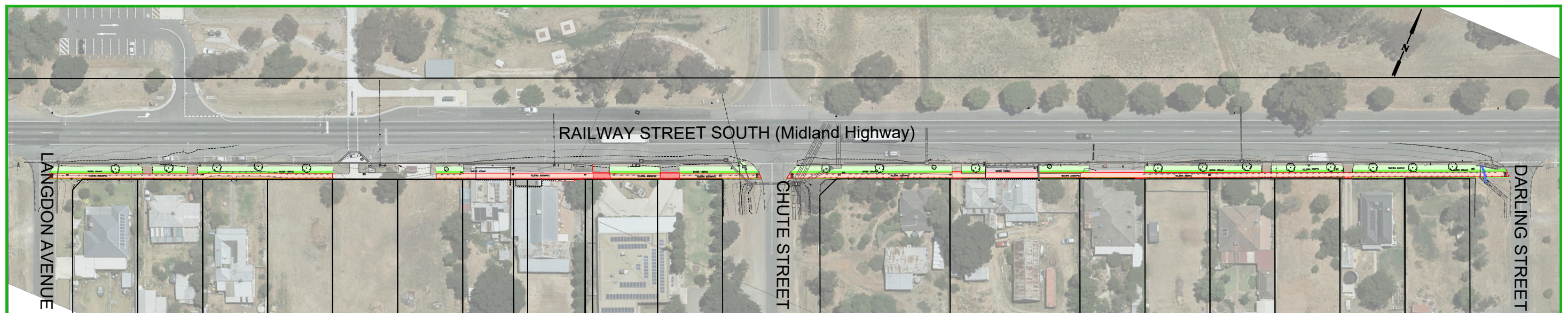

PROJECT EXTENTS

APPROVAL TO CONSTRUCT STAMP	PROJECT PLANNING REQUIREMENTS	CITY OF GREATER BENDIGO	PROJECT DESIGN STATUS	PROJECT DETAILS	SHEET DETAILS																																																															
DO NOT CONSTRUCT WITHOUT STAMP	<table border="1"> <thead> <tr> <th>Item</th> <th>Required</th> <th>Approved</th> <th>Comments</th> </tr> </thead> <tbody> <tr> <td>Vegetation</td> <td>No</td> <td>No</td> <td>-</td> </tr> <tr> <td>DTP - Vicroads</td> <td>Yes</td> <td>No</td> <td>For comment only</td> </tr> <tr> <td>CMA</td> <td>No</td> <td>No</td> <td>-</td> </tr> <tr> <td>Planning Permit</td> <td>No</td> <td>No</td> <td>-</td> </tr> <tr> <td>Land Acquisition</td> <td>No</td> <td>No</td> <td>-</td> </tr> <tr> <td>CHMP</td> <td>No</td> <td>No</td> <td>-</td> </tr> <tr> <td>Other</td> <td>No</td> <td>No</td> <td>-</td> </tr> </tbody> </table>		Item	Required	Approved	Comments	Vegetation	No	No	-	DTP - Vicroads	Yes	No	For comment only	CMA	No	No	-	Planning Permit	No	No	-	Land Acquisition	No	No	-	CHMP	No	No	-	Other	No	No	-	<table border="1"> <tbody> <tr> <td>Surveyor:</td> <td>H. WHYTOCK</td> <td>07/04/2023</td> </tr> <tr> <td>Designer:</td> <td>A. SMITH</td> <td>12/05/2023</td> </tr> <tr> <td>Draft Checked:</td> <td>L. OLIVER</td> <td>xx/xx/23</td> </tr> <tr> <td>Tender Approved:</td> <td>N. SARTORI</td> <td>xx/xx/23</td> </tr> </tbody> </table>	Surveyor:	H. WHYTOCK	07/04/2023	Designer:	A. SMITH	12/05/2023	Draft Checked:	L. OLIVER	xx/xx/23	Tender Approved:	N. SARTORI	xx/xx/23	<p>Location: Railway Place South</p> <p>Suburb: Goornong</p> <p>Works: Footpath</p> <p>GB No: GB5078</p>	<p>COVER SHEET</p> <p>Sheet number: 1 of 10</p> <p>Plan Scale: - A3</p> <p>Plotted: 30/05/2023 By: Andrew Smith</p> <table border="1"> <thead> <tr> <th colspan="4">SHEET REVISIONS AFTER TENDER</th> </tr> <tr> <th>Revision</th> <th>Description</th> <th>Approved by</th> <th>Date</th> </tr> </thead> <tbody> <tr> <td>-</td> <td>-</td> <td>-</td> <td>-</td> </tr> <tr> <td>-</td> <td>-</td> <td>-</td> <td>-</td> </tr> <tr> <td>-</td> <td>-</td> <td>-</td> <td>-</td> </tr> </tbody> </table>	SHEET REVISIONS AFTER TENDER				Revision	Description	Approved by	Date	-	-	-	-	-	-	-	-	-	-	-
	Item	Required	Approved	Comments																																																																
Vegetation	No	No	-																																																																	
DTP - Vicroads	Yes	No	For comment only																																																																	
CMA	No	No	-																																																																	
Planning Permit	No	No	-																																																																	
Land Acquisition	No	No	-																																																																	
CHMP	No	No	-																																																																	
Other	No	No	-																																																																	
Surveyor:	H. WHYTOCK	07/04/2023																																																																		
Designer:	A. SMITH	12/05/2023																																																																		
Draft Checked:	L. OLIVER	xx/xx/23																																																																		
Tender Approved:	N. SARTORI	xx/xx/23																																																																		
SHEET REVISIONS AFTER TENDER																																																																				
Revision	Description	Approved by	Date																																																																	
-	-	-	-																																																																	
-	-	-	-																																																																	
-	-	-	-																																																																	
			PRELIMINARY DESIGN DRAFT 4																																																																	

CONSTRUCTION SPECIFICATIONS

All construction undertaken by, or on behalf of, The City of Greater Bendigo (CoGB) shall be undertaken in accordance with all DTP/Vicroads 200-700 series of Standard Specifications.

Compliance with the specifications to the satisfaction of the project Superintendent is required before a project can meet Practical Completion.

Sections of the DTP/Vicroads 200-700 series of standard specifications which are of particular relevance for this project include:

FORMATION

- 201 Site Clearing
- 204 Earthworks

FLEXIBLE PAVEMENTS

- 304 Unbound Flexible Pavement Construction
- 310 Preparation of Granular Pavements for Bituminous Surfacing

ASPHALT AND SURFACE TREATMENTS

- 407 Dense Graded Asphalt
- 408 Sprayed Bituminous Surfacing

INCIDENTAL CONSTRUCTION

- 701 Underground Stormwater Drains
- 702 Subsurface Drainage
- 703 General Concrete Paving
- 705 Drainage Pits and Covers

MATERIAL SPECIFICATIONS

FOR WORKS DEPARTMENT

All materials used in construction projects undertaken by the CoGB Works department shall be compliant with the specifications set out in the relevant CoGB material panel supply contract.

Where panel supply contract information is not available, material specifications shall be sought from and supplied by the CoGB Engineering Department, and all materials used in construction must comply with those specifications.

FOR EXTERNAL CONSULTANTS (inc. contractors engaged by the Works Dept.)

All materials used by external contractors engaged to undertake CoGB construction projects, or components thereof, shall be as per the material specification supplied within the instrument of engagement (Quote, Tender or Contract), or as per written instruction from the project Superintendents.

PROJECT PLANNING REQUIREMENTS

Permits and approvals

1. Project permits and approvals which were required to be obtained prior to construction are listed in the below table
2. Construction activities must be compliant with all conditions within the listed permits and approvals.

PROJECT PLANNING REQUIREMENTS			
Item	Required	Approved	Comments
Vegetation	No	No	-
DTP - Vicroads	Yes	No	For comment only
CMA	No	No	-
Planning Permit	No	No	-
Land Acquisition	No	No	-
CHMP	No	No	-
Other	No	No	-

GENERAL NOTES

STANDARD DRAWINGS

Standard Drawings that are referenced within the design drawings are noted as 'SD', and are sourced from 3 locations. They are available for download online or from the project superintendent:

1. 'CoGB SD' are sourced from the City of Greater Bendigo
<https://www.bendigo.vic.gov.au/Services/Roads-and-Drainage/Roads/Construction-standards>
2. 'IDM SD' are sourced from the Infrastructure Design Manual
<https://www.designmanual.com.au/>
3. 'Vicroads SD' are sourced from Vicroads
<https://www.vicroads.vic.gov.au/business-and-industry/technical-publications/technical-drawings-for-roadworks/standard-drawings-for-roadworks>

SERVICES SHOWN ON PLANS AND DURING CONSTRUCTION

- The location of underground services shown on design drawings have been derived from available information. Accuracy can not be guaranteed and should therefore be treated as indicative only.
- Gas and water property services are not located or shown on design drawings. It is the contractors responsibility to locate and alter these services as required to achieve the project design.
- Prior to undertaking construction activities, exact service locations must be arranged and marked onsite.
- The contractor will be held responsible for any damage caused to services.
- All service pit lids or valve covers within the works area are to be raised or lowered to match the design surface level to the relevant authority standards, unless noted otherwise on the construction plans, or by approval from the superintendent.
- Any service authority marker post found within the works area is to be relocated adjacent to their current position to a point 150mm offset from the nearest property boundary.
- Any PSM covers affected during works are to be renewed to CoGB SD293 unless noted otherwise, or by approval from the superintendent.

DRAINAGE

- Any private storm water pipes discovered during works are to be plumbed to the nearest CoGB drainage pit, or with approval from the superintendent, to the nearest kerb or pipe

CONSTRUCTION MANAGEMENT GUIDANCE

OCCUPATIONAL HEALTH AND SAFETY

Delivery units shall consider appropriate management of occupational health and safety, and develop management plans compliant with ISO45001, and the City of Greater Bendigo integrated management system prior to any works beginning onsite

SITE ENVIRONMENTAL MANAGEMENT PLAN

A Site Environmental Management Plan (SEMP) is to be developed by delivery units to manage the project site during the project delivery window. Consideration shall be given to appropriate management of the following, with a SEMP plan filled out and displayed onsite at all times:

- Communication and induction for staff, contractors and sub contractors
- Communication with appropriate adjacent residents/businesses
- Noise and Vibration
- Dust and contamination
- Chemicals
- Erosion and sediment
- Waste
- Vehicle and roadside management
- Vegetation, with particular focus on any relevant permit conditions and AS4970
- Heritage, with particular focus on any relevant permit conditions

TRAFFIC MANAGEMENT PLAN

Where appropriate and prior to any works starting on site, delivery units must organise a AS1742.3 compliant traffic management plan, and have it approved by the relevant road authority.

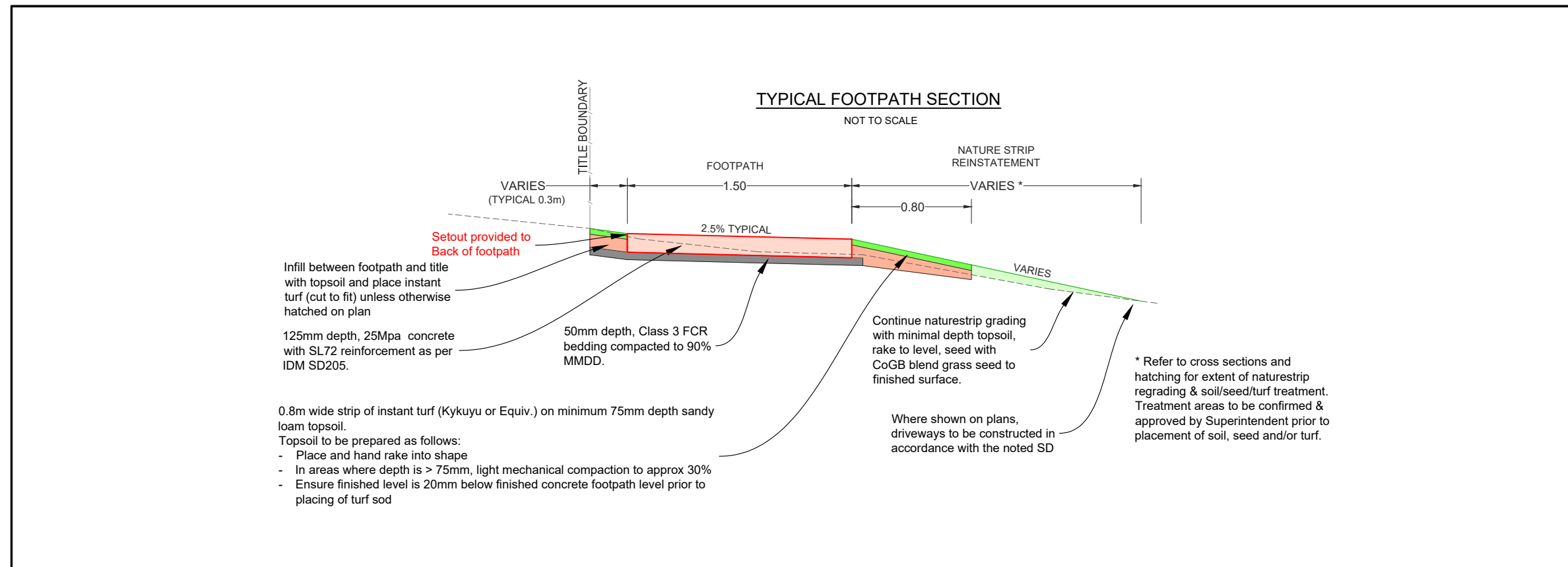

BEFORE YOU DIG
www.byda.com.au
Zero Damage - Zero Harm

IMPORTANT!
The location of underground services have been derived from available information, however accuracy cannot be guaranteed. All existing service information should therefore be treated as indicative only, and service locations must be arranged prior to commencement of any excavation. The contractor will be held responsible for any damage caused to underground services.



PROJECT DESIGN STATUS		
Surveyor:	H. WHYTOCK	07/04/2023
Designer:	A. SMITH	12/05/2023
Draft Checked:	L. OLIVER	xx/xx/23
Tender Approved:	N. SARTORI	xx/xx/23

PRELIMINARY DESIGN DRAFT 4

PROJECT DETAILS	
Location:	Railway Place South
Suburb:	Goornong
Works:	Footpath
GB No:	GB5078

SHEET DETAILS			
GENERAL NOTES		Sheet number:	2 of 10
		Plan Scale:	NTS A3
Plotted: 30/05/2023 By: Andrew Smith			
SHEET REVISIONS AFTER TENDER			
Revision	Description	Approved by	Date
-	-	-	-
-	-	-	-
-	-	-	-

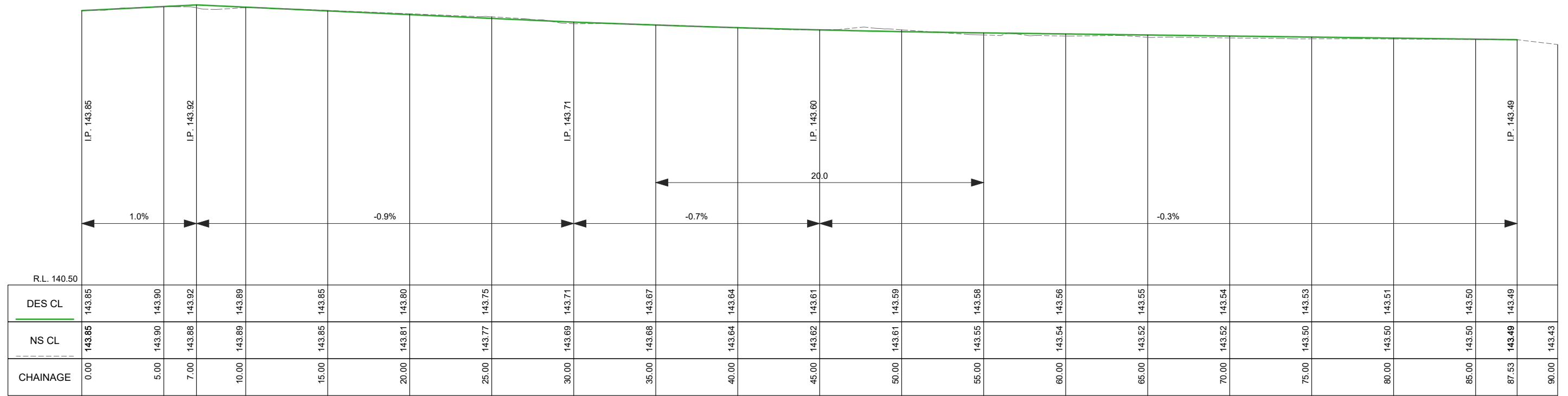
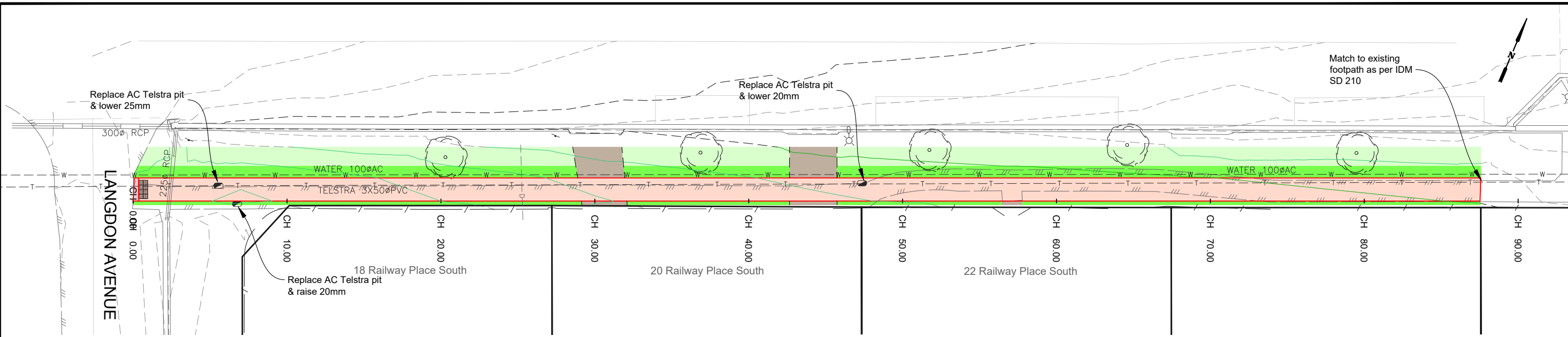

FP LONGITUDINAL SECTION CH 0.000 To 90.000
 SCALES: H 1:250 V 1:50 (A3)

LEGEND			
	DESIGN CONTOURS - Levels to AHD (0.10m interval)		Concrete Footpath area: Normal plain Footpath as per IDM SD 205 & SD210
	EXISTING CONTOURS - Levels to AHD (0.10m interval)		Concrete Driveway area: Industrial plain Dwy as per IDM SD250
	Concrete Kerb area: Normal plain Kerb per IDM SD100 & CoGB SD190,191,192		Gravel Driveway area: 50mm depth Class 3 FCR
	Landscape work: Instant turf (Refer: Typical details pg 2)		Landscape work: topsoil and seed (Refer: Typical details pg 2)
	Landscape work: Proposed Tree Plant as directed by CoGB Parks		Existing tree to be removed



PROJECT DESIGN STATUS		
Surveyor:	H. WHYTOCK	07/04/2023
Designer:	A. SMITH	12/05/2023
Draft Checked:	L. OLIVER	xx/xx/23
Tender Approved:	N. SARTORI	xx/xx/23

**PRELIMINARY DESIGN
DRAFT 4**

PROJECT DETAILS	
Location:	Railway Place South
Suburb:	Goornong
Works:	Footpath
GB No:	GB5078

SHEET DETAILS			
DETAIL LAYOUT & LONG SECTION		Sheet number:	3 of 10
		Plan Scale:	1:250 A3
Plotted: 30/05/2023 By: Andrew Smith			
SHEET REVISIONS AFTER TENDER			
Revision	Description	Approved by	Date
-	-	-	-
-	-	-	-
-	-	-	-

RAILWAY STREET SOUTH (Midland Highway)

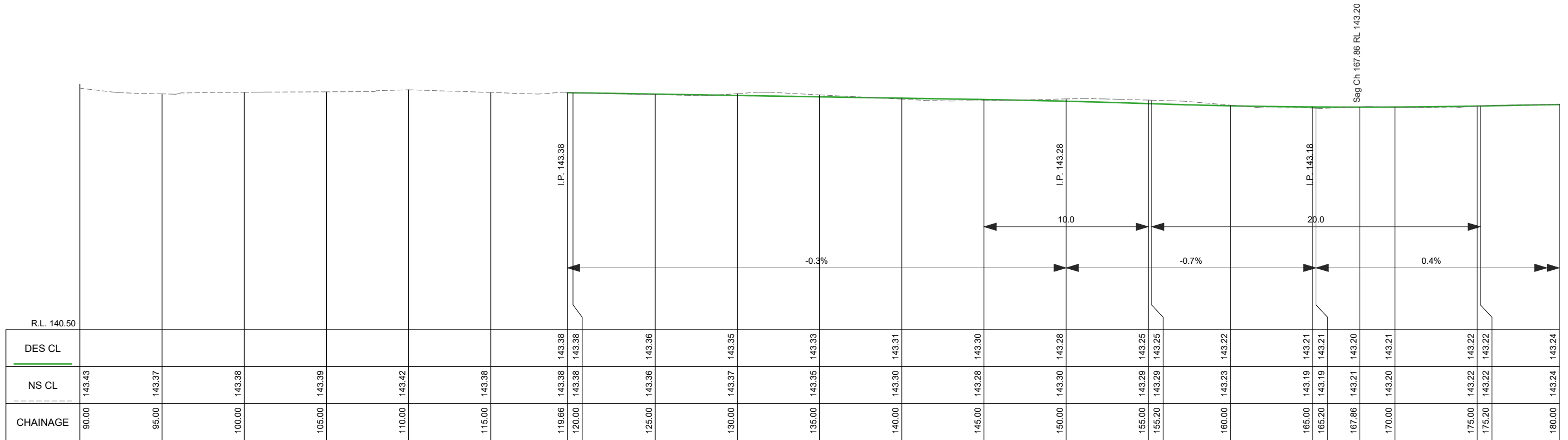
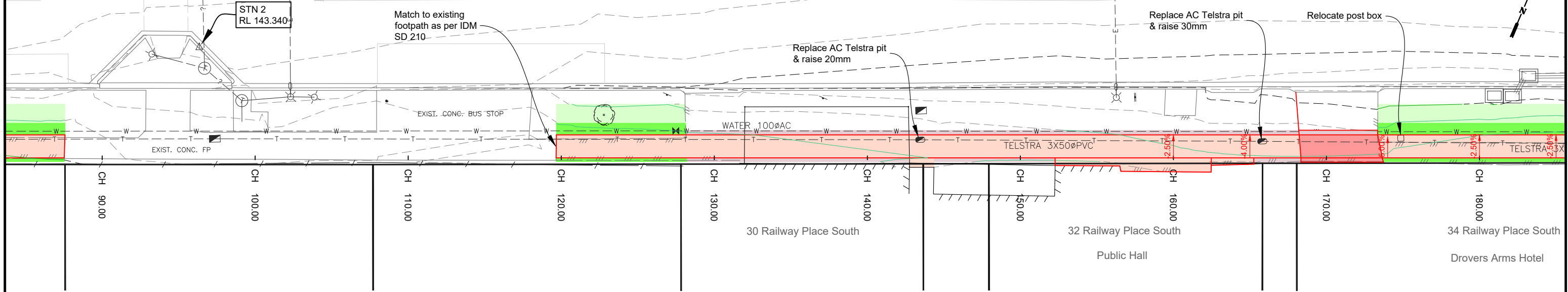

FP LONGITUDINAL SECTION CH 90.000 To 180.000
 SCALES: H 1:250 V 1:50 (A3)

LEGEND			PROJECT DESIGN STATUS			PROJECT DETAILS			SHEET DETAILS												
	DESIGN CONTOURS - Levels to AHD (0.10m interval)		Concrete Footpath area: Normal plain Footpath as per IDM SD 205 & SD210		Asphalt Driveway area: as per IDM SD206		Landscape work: Instant turf (Refer: Typical details pg 2)	Surveyor:	H. WHYTOCK	07/04/2023	Location: Railway Place South Suburb: Goornong Works: Footpath GB No: GB5078	DETAIL LAYOUT & LONG SECTION Sheet number: 4 of 10 Plan Scale: 1:250 A3 Plotted: 30/05/2023 By: Andrew Smith									
	EXISTING CONTOURS - Levels to AHD (0.10m interval)		Concrete Driveway area: Industrial plain Dwy as per IDM SD250		Gravel Driveway area: 50mm depth Class 3 FCR		Landscape work: topsoil and seed (Refer: Typical details pg 2)	Designer:	A. SMITH	12/05/2023											
	Concrete Kerb area: Normal plain Kerb per IDM SD100 & CoGB SD190,191,192		Concrete Driveway area: Normal plain Dwy as per IDM SD240		Landscape work: Proposed Tree Plant as directed by CoGB Parks		Existing tree to be removed	Draft Checked:	L. OLIVER	xx/xx/23											
								Tender Approved:	N. SARTORI	xx/xx/23											
						<p style="text-align: center; border: 2px solid red; padding: 5px;">PRELIMINARY DESIGN DRAFT 4</p>			SHEET REVISIONS AFTER TENDER												
									<table border="1"> <thead> <tr> <th>Revision</th> <th>Description</th> <th>Approved by</th> <th>Date</th> </tr> </thead> <tbody> <tr><td>-</td><td>-</td><td>-</td><td>-</td></tr> <tr><td>-</td><td>-</td><td>-</td><td>-</td></tr> <tr><td>-</td><td>-</td><td>-</td><td>-</td></tr> </tbody> </table>			Revision	Description	Approved by	Date	-	-	-	-	-	-
Revision	Description	Approved by	Date																		
-	-	-	-																		
-	-	-	-																		
-	-	-	-																		

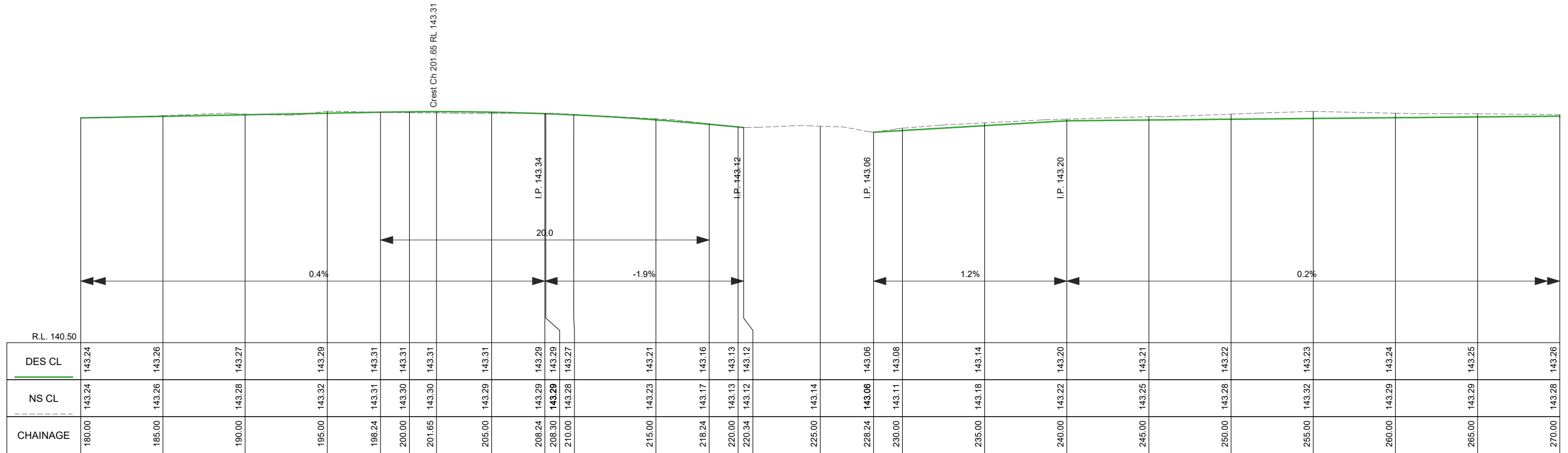
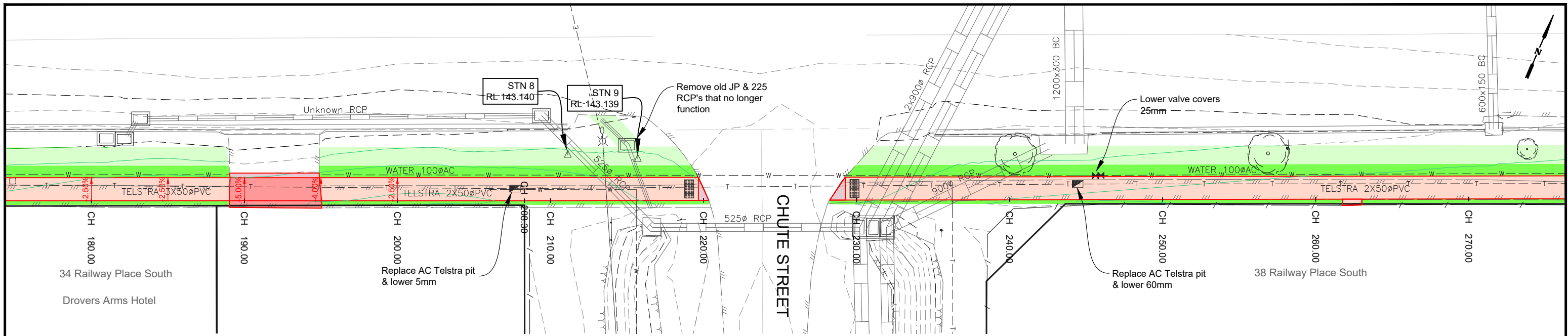

LEGEND

DESIGN CONTOURS - Levels to AHD (0.10m interval)	Concrete Footpath area: Normal plain Footpath as per IDM SD 205 & SD210	Asphalt Driveway area: as per IDM SD206	Landscape work: Instant turf (Refer: Typical details pg 2)
EXISTING CONTOURS - Levels to AHD (0.10m interval)	Concrete Driveway area: Industrial plain Dwy as per IDM SD250	Gravel Driveway area: 50mm depth Class 3 FCR	Landscape work: topsoil and seed (Refer: Typical details pg 2)
Concrete Kerb area: Normal plain Kerb per IDM SD100 & CoGB SD190,191,192	Concrete Driveway area: Normal plain Dwy as per IDM SD240	Landscape work: Proposed Tree Plant as directed by CoGB Parks	Existing tree to be removed



PROJECT DESIGN STATUS

Surveyor:	H. WHYTOCK	07/04/2023
Designer:	A. SMITH	12/05/2023
Draft Checked:	L. OLIVER	xx/xx/23
Tender Approved:	N. SARTORI	xx/xx/23

PRELIMINARY DESIGN DRAFT 4

PROJECT DETAILS

Location: Railway Place South
 Suburb: Goornong
 Works: Footpath
 GB No: GB5078

SHEET DETAILS

DETAIL LAYOUT & LONG SECTION

Sheet number: 5 of 10
 Plan Scale: 1:250
 Plotted: 30/05/2023 By: Andrew Smith

SHEET REVISIONS AFTER TENDER

Revision	Description	Approved by	Date
-	-	-	-
-	-	-	-
-	-	-	-

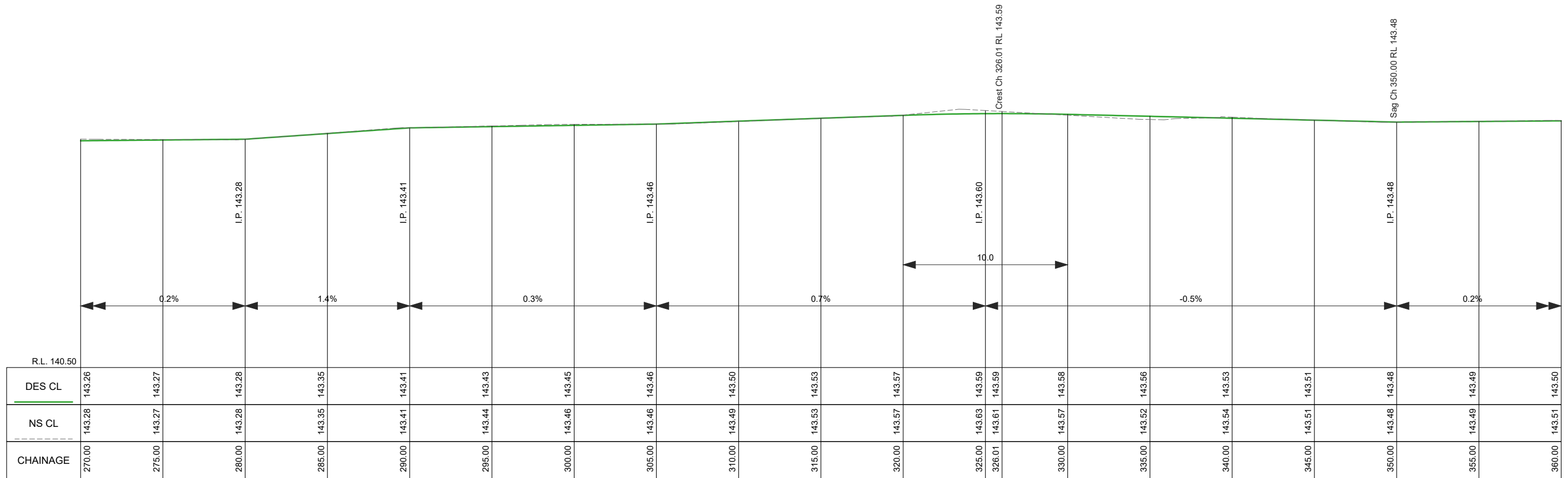
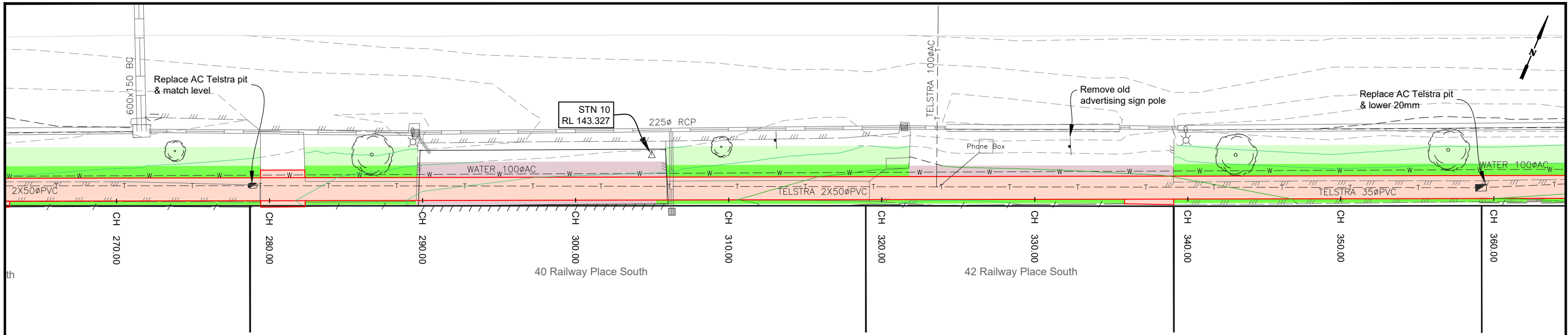

FP LONGITUDINAL SECTION CH 270.000 To 360.000
 SCALES: H 1:250 V 1:50 (A3)

LEGEND			
	DESIGN CONTOURS - Levels to AHD (0.10m interval)		Concrete Footpath area: Normal plain Footpath as per IDM SD 205 & SD210
	EXISTING CONTOURS - Levels to AHD (0.10m interval)		Concrete Driveway area: Industrial plain Dwy as per IDM SD250
	Concrete Kerb area: Normal plain Kerb per IDM SD100 & CoGB SD190,191,192		Gravel Driveway area: 50mm depth Class 3 FCR
	Landscape work: Instant turf (Refer: Typical details pg 2)		Landscape work: Proposed Tree Plant as directed by CoGB Parks
	Landscape work: topsoil and seed (Refer: Typical details pg 2)		Existing tree to be removed



PROJECT DESIGN STATUS		
Surveyor:	H. WHYTOCK	07/04/2023
Designer:	A. SMITH	12/05/2023
Draft Checked:	L. OLIVER	xx/xx/23
Tender Approved:	N. SARTORI	xx/xx/23

**PRELIMINARY DESIGN
DRAFT 4**

PROJECT DETAILS	
Location:	Railway Place South
Suburb:	Goornong
Works:	Footpath
GB No:	GB5078

SHEET DETAILS			
DETAIL LAYOUT & LONG SECTION		Sheet number:	6 of 10
		Plan Scale:	1:250
		Plotted:	30/05/2023 By: Andrew Smith
SHEET REVISIONS AFTER TENDER			
Revision	Description	Approved by	Date
-	-	-	-
-	-	-	-
-	-	-	-

RAILWAY STREET SOUTH (Midland Highway)

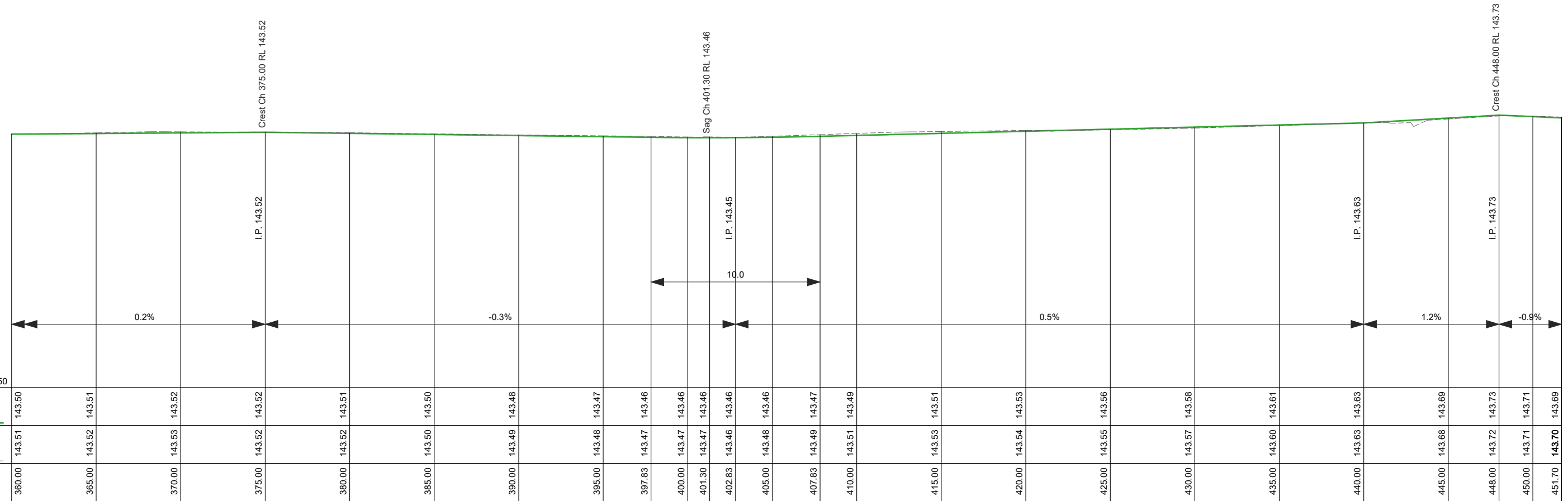
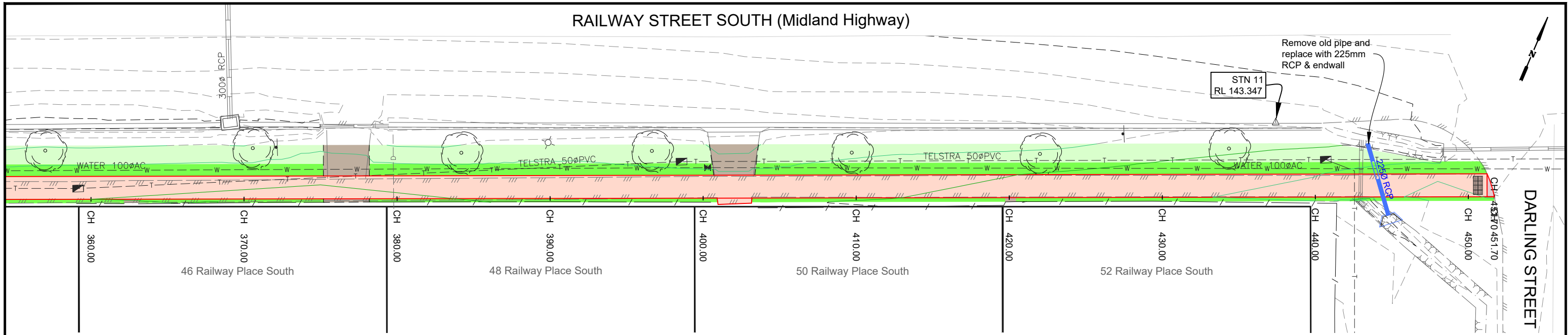

FP LONGITUDINAL SECTION CH 360.000 To 451.698
 SCALES: H 1:250 V 1:50 (A3)

LEGEND			
	DESIGN CONTOURS - Levels to AHD (0.10m interval)		Concrete Footpath area: Normal plain Footpath as per IDM SD 205 & SD210
	EXISTING CONTOURS - Levels to AHD (0.10m interval)		Concrete Driveway area: Industrial plain Dwy as per IDM SD250
	Concrete Kerb area: Normal plain Kerb per IDM SD100 & CoGB SD190,191,192		Gravel Driveway area: 50mm depth Class 3 FCR
	Landscape work: Proposed Tree Plant as directed by CoGB Parks		Landscape work: Instant turf (Refer: Typical details pg 2)
	Existing tree to be removed		Landscape work: topsoil and seed (Refer: Typical details pg 2)



PROJECT DESIGN STATUS		
Surveyor:	H. WHYTOCK	07/04/2023
Designer:	A. SMITH	12/05/2023
Draft Checked:	L. OLIVER	xx/xx/23
Tender Approved:	N. SARTORI	xx/xx/23

**PRELIMINARY DESIGN
DRAFT 4**

PROJECT DETAILS	
Location:	Railway Place South
Suburb:	Goornong
Works:	Footpath
GB No:	GB5078

SHEET DETAILS			
DETAIL LAYOUT & LONG SECTION		Sheet number:	7 of 10
		Plan Scale:	1:250
Plotted: 30/05/2023 By: Andrew Smith			
SHEET REVISIONS AFTER TENDER			
Revision	Description	Approved by	Date
-	-	-	-
-	-	-	-
-	-	-	-

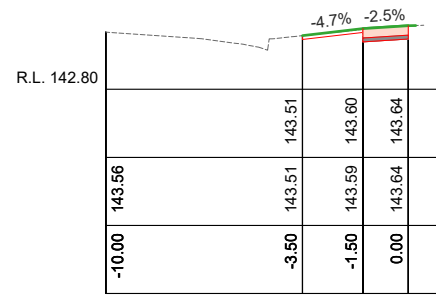

Ch 40.00

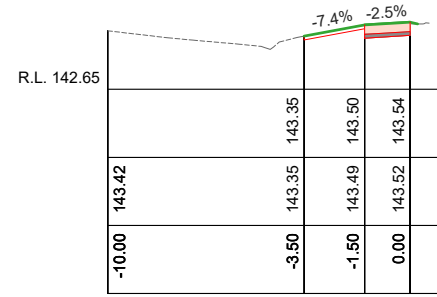

Ch 70.00

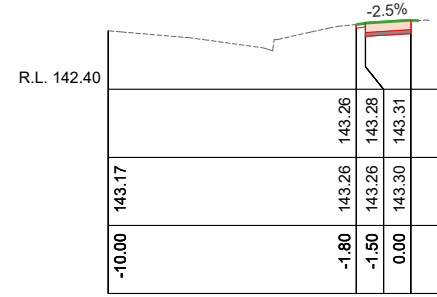

Ch 140.00

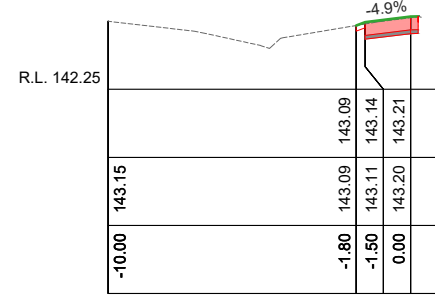

Ch 173.00

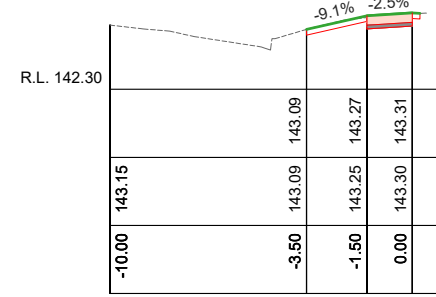

Ch 200.00

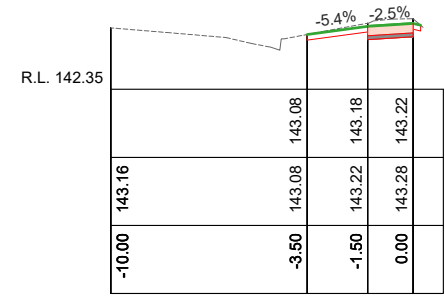

Ch 250.00

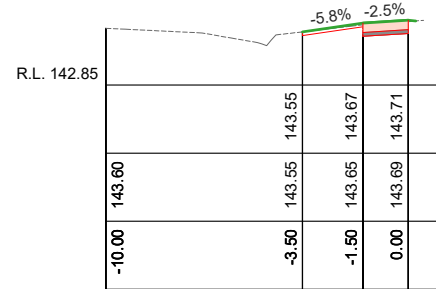

Ch 30.00

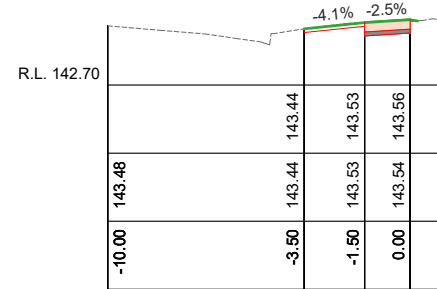

Ch 60.00

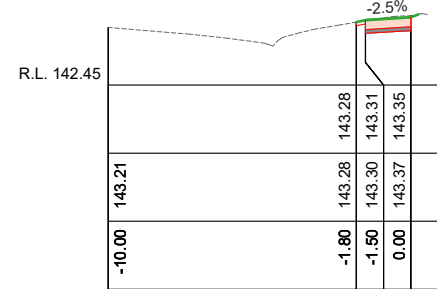

Ch 130.00

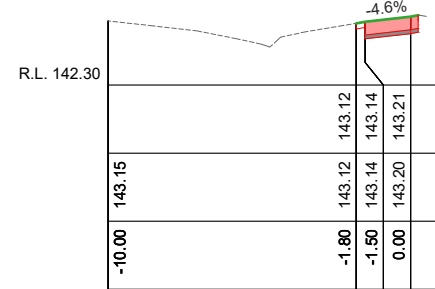

Ch 170.00

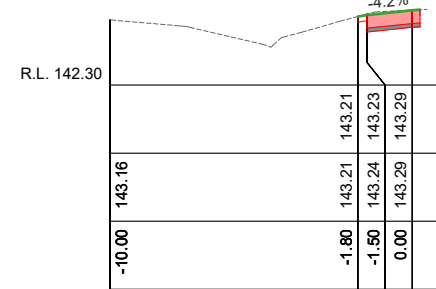

Ch 194.00

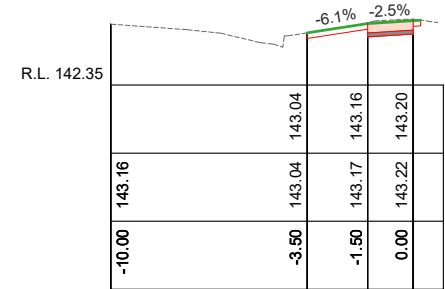

Ch 240.00

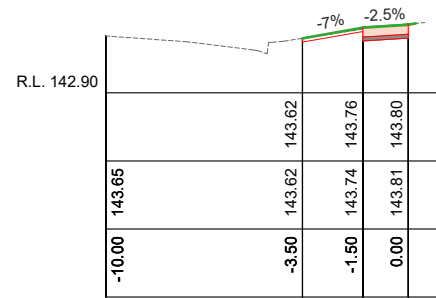

Ch 20.00

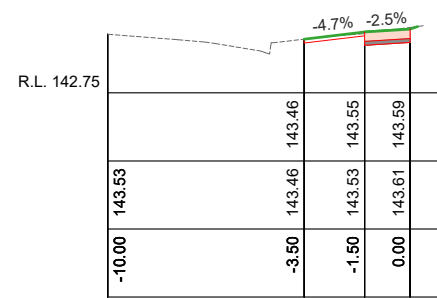

Ch 50.00

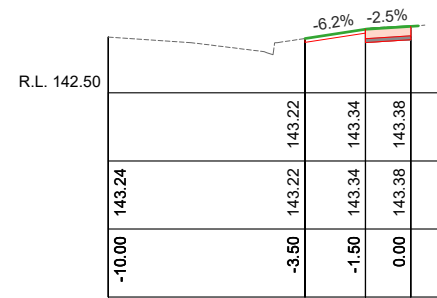

Ch 120.00

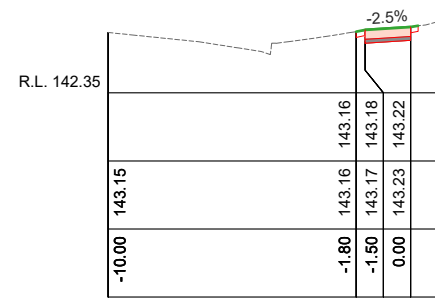

Ch 160.00

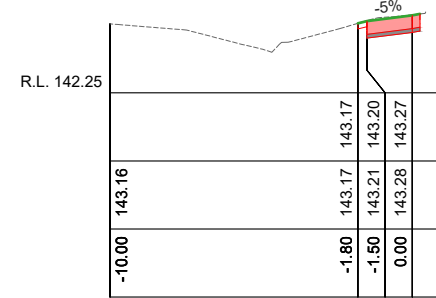

Ch 190.00

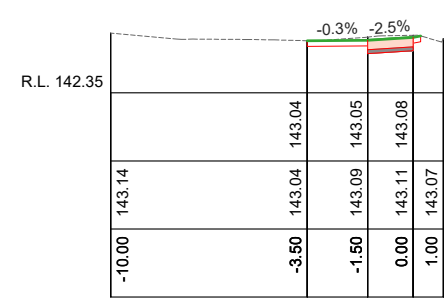

Ch 230.00

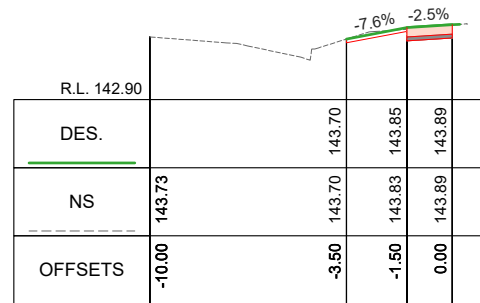

Ch 10.00

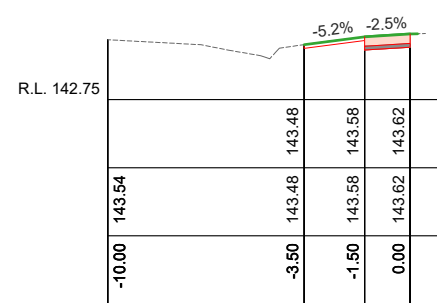

Ch 44.00

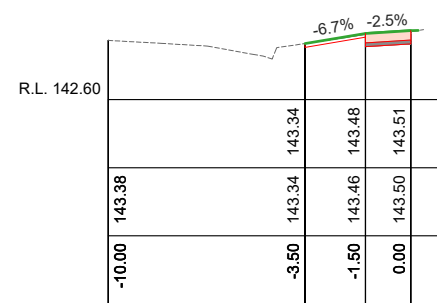

Ch 80.00

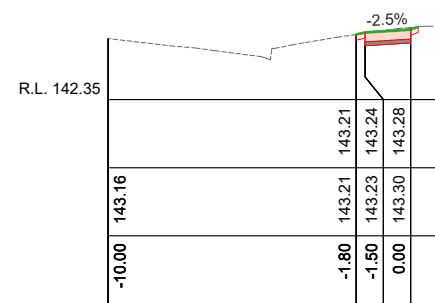

Ch 150.00

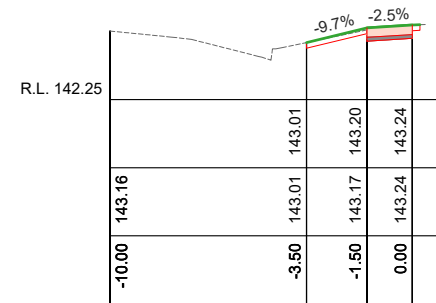

Ch 180.00

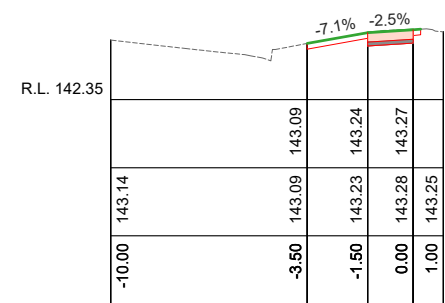

Ch 210.00

FP CROSS SECTIONS
SCALES: H 1:250 V 1:100 (A3)



PROJECT DESIGN STATUS		
Surveyor:	H. WHYTOCK	07/04/2023
Designer:	A. SMITH	12/05/2023
Draft Checked:	L. OLIVER	xx/xx/23
Tender Approved:	N. SARTORI	xx/xx/23
PRELIMINARY DESIGN DRAFT 4		

PROJECT DETAILS	
Location:	Railway Place South
Suburb:	Goornong
Works:	Footpath
GB No:	GB5078

SHEET DETAILS			
CROSS SECTIONS		Sheet number:	8 of 10
		Plan Scale:	AS SHOWN A3
		Plotted:	30/05/2023 By: Andrew Smith
SHEET REVISIONS AFTER TENDER			
Revision	Description	Approved by	Date
-	-	-	-
-	-	-	-
-	-	-	-

STATION DATA				
Point #	Description	Easting	Northing	Level
901	STN 1	276764.885	5944880.780	143.682
902	STN 2	276857.959	5944906.052	143.340
903	STN 3	276951.730	5944963.305	142.837
904	STN 4	276988.759	5944974.564	143.162
905	STN 5	277042.650	5945000.156	143.733
906	STN 6	277101.982	5945023.557	143.308
907	STN 7	277176.541	5945056.758	144.042
908	STN 8	276965.283	5944946.979	143.140
909	STN 9	276969.595	5944948.520	143.139
910	STN 10	277051.640	5944983.717	143.327
911	STN 11	277172.702	5945037.453	143.347



PROJECT DESIGN STATUS		
Surveyor:	H. WHYTOCK	07/04/2023
Designer:	A. SMITH	12/05/2023
Draft Checked:	L. OLIVER	xx/xx/23
Tender Approved:	N. SARTORI	xx/xx/23

**PRELIMINARY DESIGN
DRAFT 4**

PROJECT DETAILS	
Location:	Railway Place South
Suburb:	Goornong
Works:	Footpath
GB No:	GB5078

SHEET DETAILS			
SETOUT		Sheet number:	10 of 10
		Plan Scale:	1:XXX A3
Plotted: 30/05/2023 By: Andrew Smith			
SHEET REVISIONS AFTER TENDER			
Revision	Description	Approved by	Date
-	-	-	-
-	-	-	-
-	-	-	-